

GERPAAS® Steel lintels are designed to reinforce concrete and masonry building structures with increased strength.

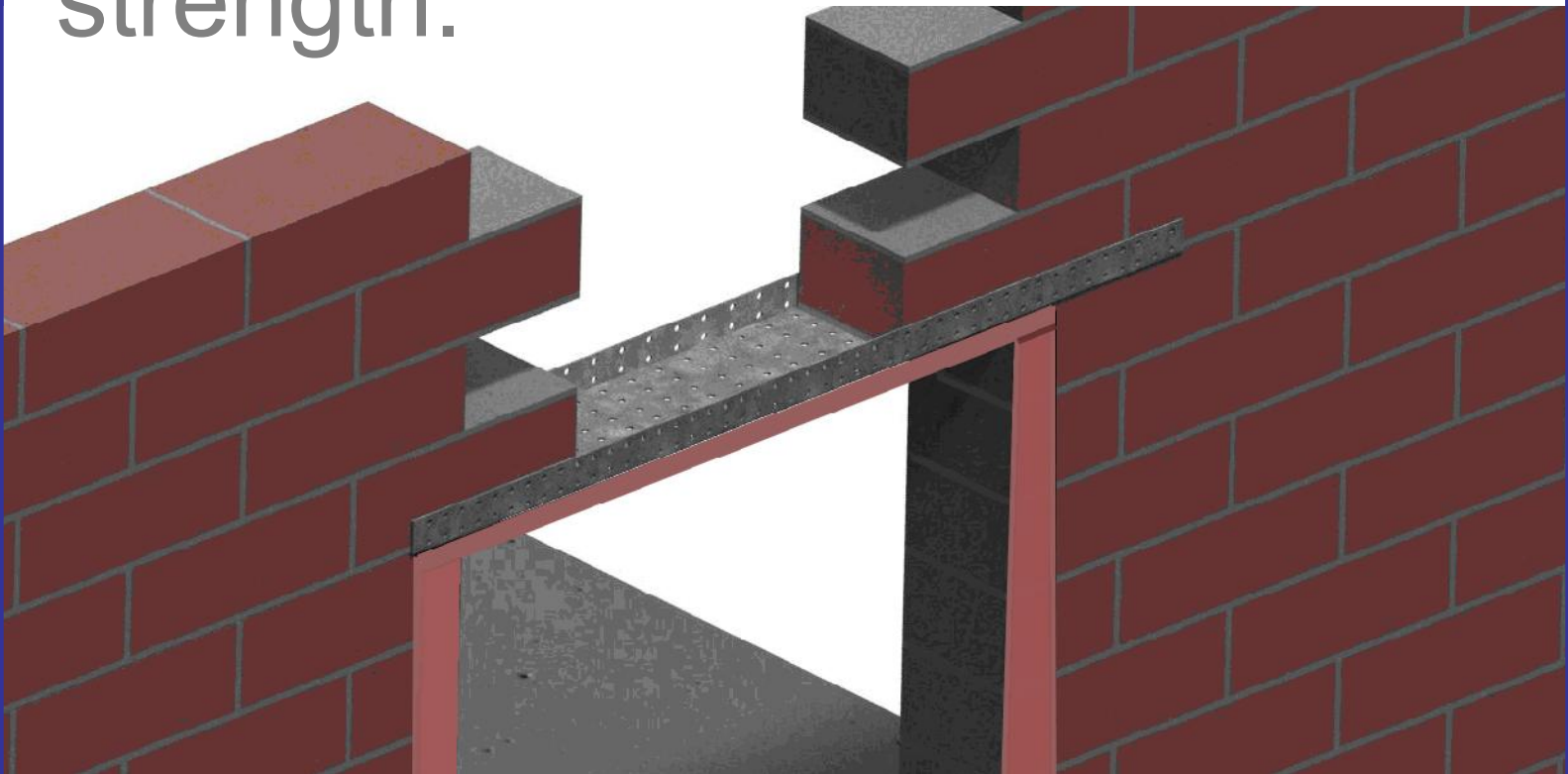

Quality

GERPAAS Steel Lintels are manufactured of hot dip galvanized carbon steel to EN 1461 / TS 914 and stainless steel material to AISI 304 & AISI 316 grade raw materials.

These lintels are supplied in plain galvanized options without electrostatic paint coatings unless otherwise requested.

GERPAAS is an ISO 9001 certified manufacturer.

Smart Design

Lintel product ranges are designed to withstand the required load bearings in building industry in accordance with the international standards.

The perforated surface of the Gerpaas Lintels simply bonds the structure as the concrete & mortar bedding holds the structure enabling a strong mechanical endurance.

Guaranteed Quality

Gerpaas Lintels are designed for use in residential and industrial buildings as wall support units in concrete and masonry walls and are supplied in manufacturer's guarantee against mechanical defects.

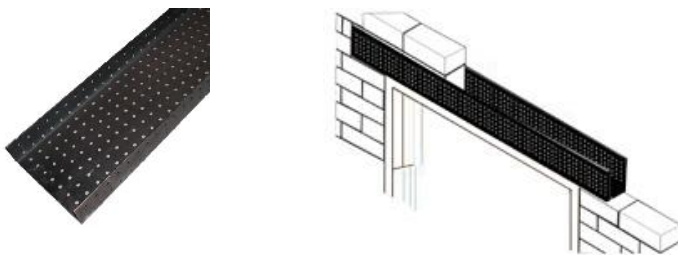

Accessories

The support brackets are designed to suit the Gerpaas lintels in all applications.



Custom Production

We accept custom production requirements for our customers in steel lintel production range.

Our capabilities for custom production include custom dimensions, and alternative material and finishing options.

Advantages

Gerpaas Steel Lintels provide strength and optimum performance in load bearing on building structures.

Another striking influence is the maximization of productivity on site due to the practical use of steel lintels.

- Speeds up productivity over 20 times compared to conventional cast in-situ system
- Drastically reduces the costs of labor
- Safe and secure storage advantage
- Maximizes structural safety on walls
- Protected against corrosion
- Easy to unload, lift, carry and install
- Safe working load capacities calculated



The recent earthquake regulations in the national construction codes in the field of seismic protection oblige new application methods which cause eventual renovations in the industry.

These changes have affected the conventional techniques and materials as well as the applications. In constructions of prestigious structures, the use of contemporary hardware and materials such as the steel lintels come on the first place. On wall making applications the use of steel lintels mechanically strengthens the durability of the walls, and eventually the entire structure against vibrations, seismic movements. It also speeds up the installation process which dramatically reduces the labor costs.

Additionally, due to the simplicity of this technique, steel lintel system is much more preferred by the working foremen and the workers. The components of the steel lintels are door & window lintels, vertical & horizontal beams, and fixing accessories. Steel lintel system, one of the main components of the building constructions in modern countries, is becoming prevalent in the global construction industry.

Application:

Steel lintel mounted above elevator doors.

Application made with the wet system using mortar.

TECHNICAL SPECIFICATIONS

Lengths:

Gerpaas lintels are available in 3 meter lengths. Custom lengths available upon request.

Widths:

Custom widths available upon request.

Perforations:

All perforations are round type and provide spacing to allow mortar filling after installation. Diameter of the holes are Ø5,5mm.

Standard finishes:

Hot dip pregalvanized finish to ISO EN 10142 / BS 2989

Hot dip galvanized finish to ISO EN 1461 / BS 729

Epoxy class electrostatic paint in RAL color classification codes

Electro zinc plating to TS 149

Prime coating

Delivery:

Lintels are delivered in lengths. Steel lintels are packed in couples (one inside another).

All steel lintel lengths are strapped onto wooden pallets. Other accessories are delivered in cardboardboxes or bags, placed on wooden pallets and shrinkwrapped where necessary.

Use:

Cracked or damaged steel lintels should not be used.

Lintels should not be custom cut and installed by unauthorized personnel.

Chemical characteristics:

Typical chemical characteristics of the steel grade used in general.

C%	MN	P	S	SI	AL	CU	CR	NI	MO	CEQ	*
0,06	0,519	0,014	0,006	0,144	0,035	0,025	0,023	0,026	0,003	0,156	-

Values may differ in grade changes or in different batches.



ITEM NO	W	T	A	WEIGHT Kg/m	LOAD CAPACITY Kg/m
GE-LN 1-01	85	2	50	2,7	500
GE-LN 1-02	85	2,5	50	3,4	800
GE-LN 1-03	85	3	50	4	1200
GE-LN 1-04	135	2	50	3,4	500
GE-LN 1-05	135	2,5	50	4,2	800
GE-LN 1-06	135	3	50	5,1	1200
GE-LN 1-07	190	2	50	4,2	400
GE-LN 1-08	190	2,5	50	5,2	700
GE-LN 1-09	190	3	50	6,3	1000
GE-LN 1-10	100	2	50	3,1	500
GE-LN 1-11	100	3	50	4,7	800
GE-LN 2-01	85	3	50	5,1	1600
GE-LN 2-02	85	2,5	75	4,3	1200
GE-LN 2-03	135	2,5	75	5,1	1200
GE-LN 2-04	135	3	75	6,2	1550
GE-LN 2-05	190	2,5	75	6,1	1200
GE-LN 2-06	190	3	75	7,4	1500
GE-LN 2-07	190	4	75	9,8	1900

ITEM NO	W	T	A	L	WEIGHT Kg/m
GE-LNK 01	100	10	100	100	0,800
GE-LNK 02	150	10	100	100	1,200
GE-LNK 03	200	10	100	150	2,400
GE-LNK 04	250	10	100	150	3,00

ITEM NO	W	T	A	L	WEIGHT Kg/m
GE-LNDS 01	70	2	50	100	0,170
GE-LNDS 02	100	2	50	100	1,240
GE-LNDS 03	150	2	50	100	0,360
GE-LNDS 04	200	2	50	100	0,480

GERPAAS

Maltepe san.sit. F-21 Maltepe 34852 Istanbul Turkey

T: +90 216 489 70 05 F: +90 216 417 26 44

www.gerpaas.com info@gerpaas.com