

TECHNICAL SPECIFICATIONS

Lengths:

Gerpaas lintels are available in 3 meter lengths. Custom lengths available upon request.

Widths:

Custom widths available upon request.

Perforations:

All perforations are round type and provide spacing to allow mortar filling after installation.

Quality:

Lintels are manufactured, tested and quality controlled at our own premises to ensure complete customer satisfaction.

Standard finishes:

Hot dip pregalvanized finish	to ISO EN 10142 / BS 2989
Hot dip galvanized finish	to ISO EN 1461 / BS 729
Epoxy class electrostatic paint	in RAL color classification codes
Electro zinc plating	to TS 149

Delivery:

Lintels are delivered in lengths. Steel lintels are packed in couples (one inside another). All steel lintel lengths are strapped onto wooden pallets. Other accessories are delivered in cardboardboxes or bags, placed on wooden pallets and shrinkwrapped where necessary.

Use:

Cracked or damaged steel lintels should not be used.
Lintels should not be custom cut and installed by unauthorized personnel.

LİNTELS



The recent earthquake regulations in the national construction codes in the field of seismic protection oblige new application methods which cause eventual renovations in the industry. These changes have affected the conventional techniques, and materials as well as the applications. In constructions of prestigious structures, the use of contemporary hardware and materials such as the steel lintels come on the first place. On wall making applications the use of steel lintels mechanically strengthens the durability of the walls, and eventually the entire

structure against vibrations, seismic movements. It also speeds up the installation process which dramatically reduces the labor costs. Additionally, due to the simplicity of this technique, steel lintel system is much more preferred by the working foremen and the workers.

The components of the steel lintels are door & window lintels, vertical & horizontal beams, and fixing accessories. Steel lintel system, one of the main components of the building constructions in modern countries, is becoming prevalent in the Turkish construction industry.



GERPAAS lintels

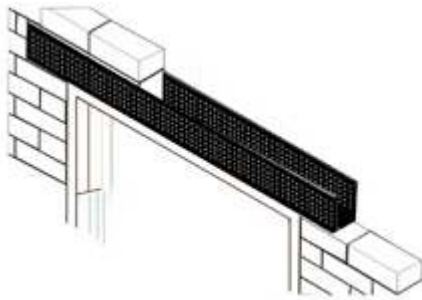

Ordering Information

Product references are obtained by giving the item number followed by the finish suffix.

EXAMPLE:

For a hot dip galvanized 85mm wide, 75mm high steel lintel:

GE-LN2-02 HDG

Pack*	Part no.	
1	GE-LN1-01	
1	GE-LN1-02	
1	GE-LN1-03	
1	GE-LN1-04	
1	GE-LN1-05	
1	GE-LN1-06	
1	GE-LN1-07	
1	GE-LN1-08	
1	GE-LN1-09	
1	GE-LN1-10	• Length: up to 3m
1	GE-LN1-11	
1	GE-LN2-01	• All lintels are supplied singly with no additional accessories included.
1	GE-LN2-02	
1	GE-LN2-03	
1	GE-LN2-04	
1	GE-LN2-05	
1	GE-LN2-06	
1	GE-LN2-07	
1+	LNK	• 90 degree brackets are available in all lintel widths. • Top, inside, outside lids available in square and gusset type options.
1+	LNDS	• 90 degree support elements are available in all lintel widths.

* Quantity of items in packs may vary depending on the product sizes.

GE-LN Lintel Channel

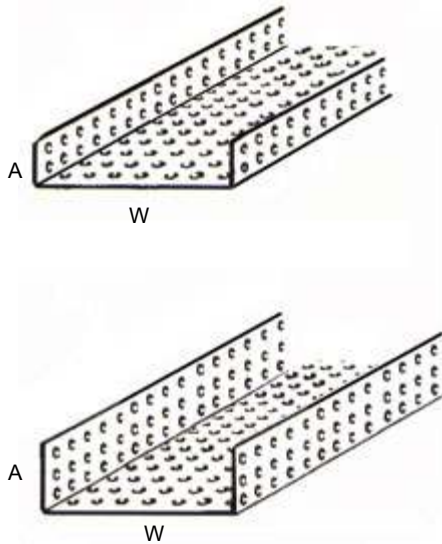

ITEM NO	WALL WIDTH	T	A	WEIGHT Kg/m	LOAD CAPACITY Kg/m
GE-LN 1- 01	85	2	50	2,7	500
GE-LN 1- 02	85	2,5	50	3,4	800
GE-LN 1- 03	85	3	50	4	1200
GE-LN 1-04	135	2	50	3,4	500
GE-LN 1-05	135	2,5	50	4,2	800
GE-LN 1- 06	135	3	50	5,1	1200
GE-LN 1- 07	190	2	50	4,2	400
GE-LN 1- 08	190	2,5	50	5,2	700
GE-LN 1- 09	190	3	50	6,3	1000
GE-LN 1-10	100	2	50	3,1	500
GE-LN 1-11	100	3	50	4,7	800
GE-LN 2- 01	85	3	50	5,1	1600
GE-LN 2-02	85	2,5	75	4,3	1200
GE-LN 2-03	135	2,5	75	5,1	1200
GE-LN 2- 04	135	3	75	6,2	1550
GE-LN 2-05	190	2,5	75	6,1	1200
GE-LN 2- 06	190	3	75	7,4	1500
GE-LN2- 07	190	4	75	9,8	1900

Ordering Information

Product references are obtained by giving the item number followed by the finish suffix.

EXAMPLE:

For a hot dip galvanized 85mm wide, 75mm high steel lintel:

GE-LN2-02 HDG

PG	Pregalvanized	ISO EN 10142
HDG	Hot dip galvanized	ISO EN 1461
ESB	Electrostatic paint coated	RAL colors
SS4	304 grade stainless steel	AISI 304
SS6	316 grade stainless steel	AISI 316 (L)

- Available in lengths upto 3000 mm in standard.
- Custom production available on request.

Advantages

Gerpaas Steel Lintels provide strength and optimum performance in load bearing on building structures. Another striking influence is the maximization of productivity on site due to the practical use of steel lintels.

- ▶ Speeds up productivity over 20 times compared to conventional cast in-situ system
- ▶ Drastically reduces the costs of labor
- ▶ Safe and secure storage advantage
- ▶ Maximizes structural safety on walls
- ▶ Protected against corrosion
- ▶ Easy to unload, lift, carry and install
- ▶ Safe working load capacities calculated

GE-LNK Lintel Bracket

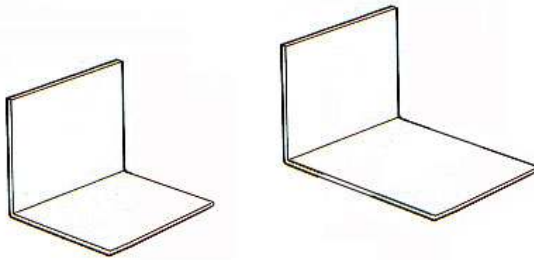

ITEM NO	T	W	A	L	WEIGHT Kg/m
GE-LNK 01	10	100	100	100	0,800
GE-LNK 02	10	150	100	100	1,200
GE-LNK 03	10	200	100	150	2,400
GE-LNK 04	10	250	100	150	3,000

• Custom production available on request.

Ordering Information

Product references are obtained by giving the item number followed by the finish suffix.

EXAMPLE:

For a hot dip galvanized 150mm wide, 100mm high steel lintel bracket:

GE-LNK-02 HDG

PG	Pregalvanized	ISO EN 10142
HDG	Hot dip galvanized	ISO EN 1461
ESB	Electrostatic paint coated	RAL colors
SS4	304 grade stainless steel	AISI 304
SS6	316 grade stainless steel	AISI 316 (L)

GE-LNDS Wall Support

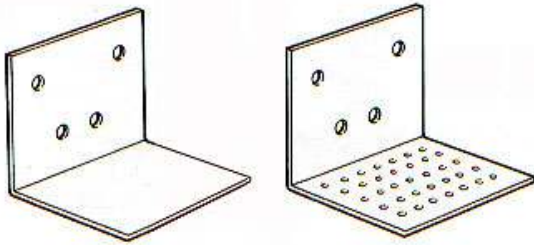

ITEM NO	T	W	A	L	WEIGHT Kg/m
GE-LNDS 01	2	70	50	100	0,170
GE-LNDS 02	2	100	50	100	0,240
GE-LNDS 03	2	150	50	100	0,360
GE-LNDS 04	2	200	50	100	0,480

• Custom production available on request.

Ordering Information

Product references are obtained by giving the item number followed by the finish suffix.

EXAMPLE:

For a hot dip galvanized 150mm wide, 100mm high steel lintel bracket:

GE-LNK-02 HDG

PG	Pregalvanized	ISO EN 10142
HDG	Hot dip galvanized	ISO EN 1461
ESB	Electrostatic paint coated	RAL colors
SS4	304 grade stainless steel	AISI 304
SS6	316 grade stainless steel	AISI 316 (L)

**GERPAAS IS THE REGISTERED TRADEMARK OF
GERPA ELECTRIC INDUSTRY AND TRADE JOINT STOCK COMPANY
REGISTERED IN ISTANBUL TURKEY.**

Address: MALTEPE SAN.SIT, G / 43
MALTEPE, 34852
ISTANBUL TURKEY

Phone: +90 216 489 70 05

Fax: +90 216 417 26 44

Web: www.gerpaas.com

Email: info@gerpaas.com

